

V2 2-6-2 TENDER LOCO
 LOCO CODE 550-100S 4771 LNER GREEN (S/C)
 551-100 BR BLACK(50'S) 60800 (S/C)
 552-100 BR GREEN 60964 (S/C)
 553-100 BR BLACK 60807 (S/C)
 554-100 BR GREEN 60903 (D/C)
 *ADD PREFIX 'T' FOR TENDER BODIES
 *ADD PREFIX 'C' FOR TENDER CHASSIS

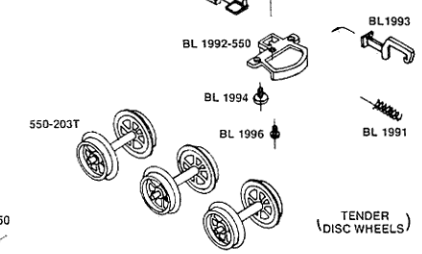
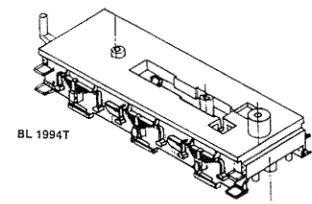
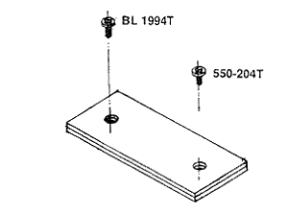
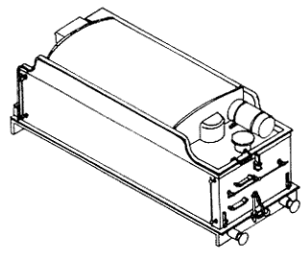
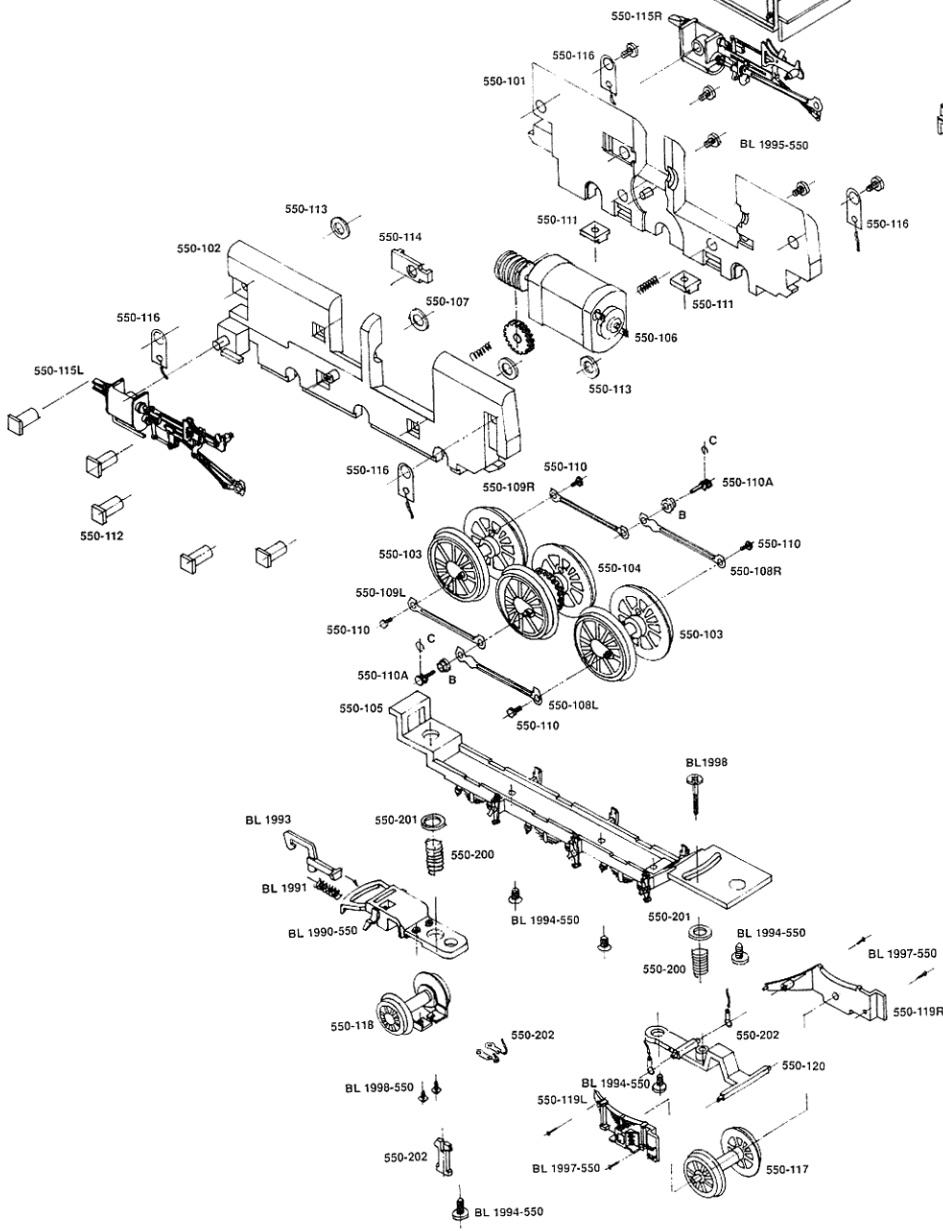

TENDER (DISC WHEELS)

PLEASE NOTE
 WE WOULD LIKE TO BRING YOUR ATTENTION TO RUNNING-IN WHICH IS NECESSARY WITH THIS TYPE OR DRIVE.
 RUN FOR APPROXIMATELY ONE HOUR TO ALLOW WORKING PARTS TO BED-IN.
 LIGHTLY OIL THE MOTOR BEARINGS AND GEARS WHEN REQUIRED.

IMPORTANT!
 When ordering any replacement parts, please ensure to quote the appropriate catalogue number/Livery of your Bachmann Locomotive in addition to the part number required.
 Please quote the running number as well if required