

# 'WARSHIP' CLASS 42 B-B DIESEL HYDRAULIC LOCOMOTIVE

## BODYSHELL CODES ( INCLUDING BASEPLATE ):-

- 050-100 MAROON ( FOXHOUND/ D817 )
- 051-100 GREEN ( ONSLAUGHT/ D832 )
- 052-100 GREEN ( ECLIPSE/ D816 )
- 054-100 BLUE ( MONARCH/ D831 )

PLEASE NOTE  
WE WOULD LIKE TO BRING  
YOUR ATTENTION TO  
RUNNING-IN WHICH IS  
NECESSARY WITH THIS TYPE  
OR DRIVE.  
RUN FOR APPROXIMATELY  
ONE HOUR TO ALLOW  
WORKING PARTS TO BED-IN.  
LIGHTLY OIL THE MOTOR  
BEARINGS AND GEARS WHEN  
REQUIRED.

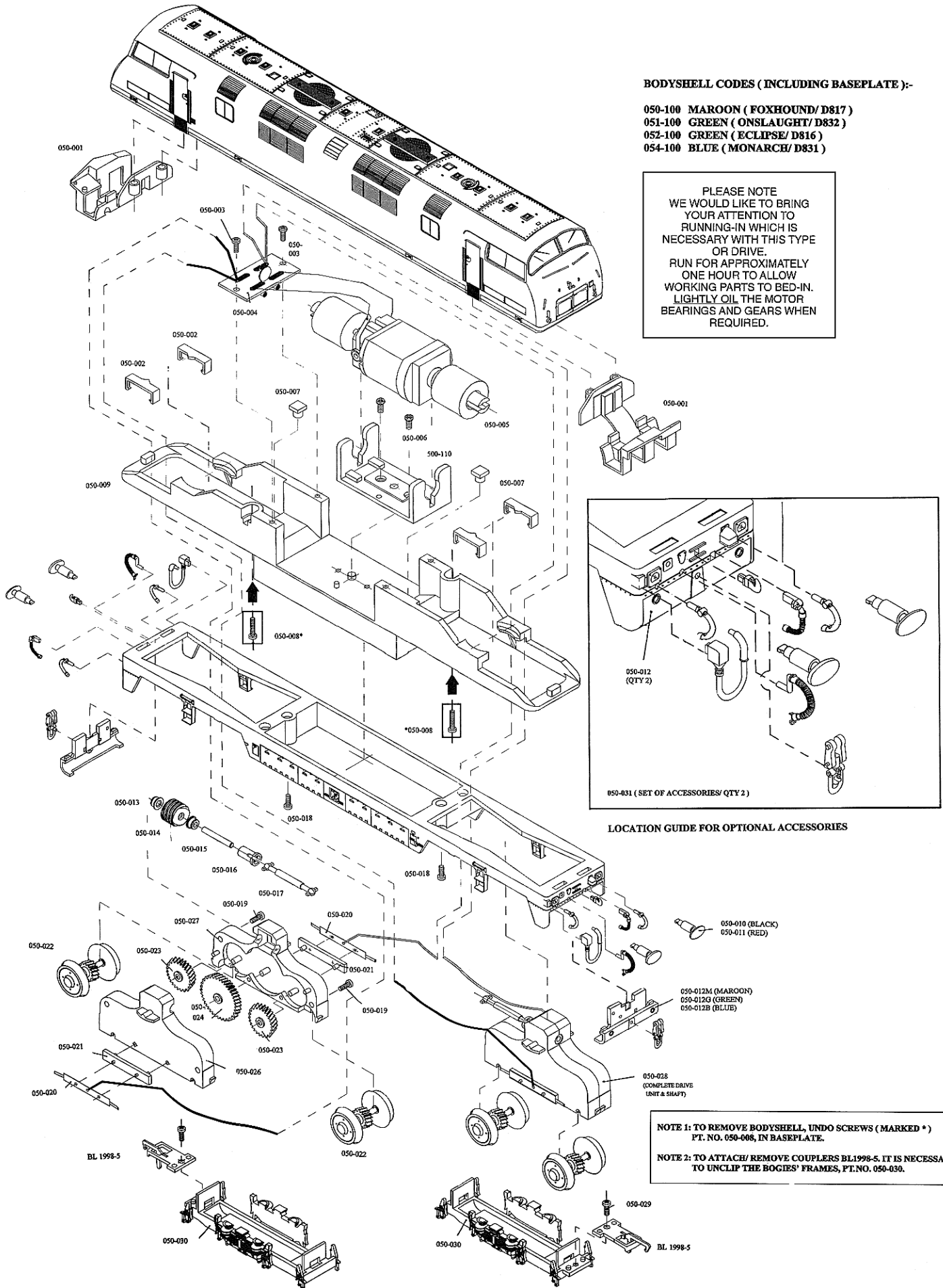

LOCATION GUIDE FOR OPTIONAL ACCESSORIES

050-010 (BLACK)  
050-011 (RED)

050-012M (MAROON)  
050-012G (GREEN)  
050-012B (BLUE)

NOTE 1: TO REMOVE BODYSHELL, UNDO SCREWS ( MARKED \* )  
PT. NO. 050-008, IN BASEPLATE.  
NOTE 2: TO ATTACH/ REMOVE COUPLERS BL1998-5, IT IS NECESSARY  
TO UNCLIP THE BOGIES' FRAMES, PT.NO. 050-030.